



Instructions Performance Off-Set Strut Tops

Page 1 of 3

N.B: This instruction sheet should be used in conjunction with the workshop manual and proper safety procedures followed.

WHITELINE Off-Set Tops are designed to offer an extra 1.0 degree of negative camber and 1.0 degree positive caster.

It is recommended that original camber and caster readings be recorded prior to install.

Application: - Hyundai I30/I30N
- Hyundai Elantra

Contents: - 2x Billet off-set Strut Tops
- with spherical bearing
- 2x lower collets
- 2x upper collets (nut)

- Raise vehicle evenly and safely support.
Never rely on a Jack only
- Proceed to remove front wheels.
- Un-bolt swaybar link
- Un-plug Strut wiring and ABS wiring.
- Loosen and remove lower hub/clevis bolt.

Note: you may have to loosen the hub nut and lower inner bushing bolt.

- Lubricate the strut leg and place a small chisel in hub behind strut to slightly spread hub.
- Remove plastic plenum cover and un-bolt the 2 strut top nuts.



N.B: It is recommended that a licenced workshop or tradesperson carry out the above procedure and that workshop manual and relevant safety procedures are followed in addition to the above.

Instructions Performance Off-Set Strut Tops

Page 2 of 3

N.B: This instruction sheet should be used in conjunction with the workshop manual and proper safety procedures followed.

- Place strut in a spring compressor and dismantle/remove OE strut top.

CAUTION - only qualified persons should compress and dismantle strut with appropriate tools



- Remove and re-use OE bump-stop and upper spring seat/bearing - these will be re-used with new strut top

Note - the bump-stop may have to be trimmed slightly for lowered vehicles.

N.B: It is recommended that a licenced workshop or tradesperson carry out the above procedure and that workshop manual and relevant safety procedures are followed in addition to the above.

Instructions Performance Off-Set Strut Tops

Page 3 of 3

Note - this product is suited to MOTORSPORT
- slight increase in NVH may be experienced.

- Place new Off-set Top on spring/
shock shaft.

**Note - upper and lower
collets as per image below**

- Tighten main upper nut to 70nm.
- Re-fit Strut to vehicle - note image
below is LH side.
- A wheel alignment is required
immediately after install.

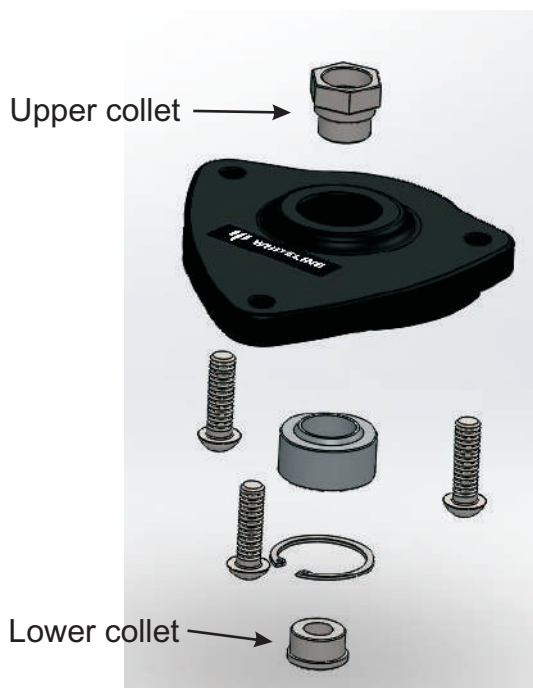

LH side shown - max camber caster

N.B: It is recommended that a licenced workshop or tradesperson carry out the above procedure and that workshop manual and relevant safety procedures are followed in addition to the above.